



# 6208-ZNR Deep groove ball bearings

- SKF Explorer

## Deep groove ball bearings

### Bearing data

[Tolerances](#),

Normal (metric), P6, P5, Normal (inch),

[Radial internal clearance](#),

Matched bearing pairs, Stainless steel  
d < 10 mm, Other bearings

### Bearing interfaces

[Seat tolerances for standard conditions](#),

[Tolerances and resultant fits](#)

## Technical specification

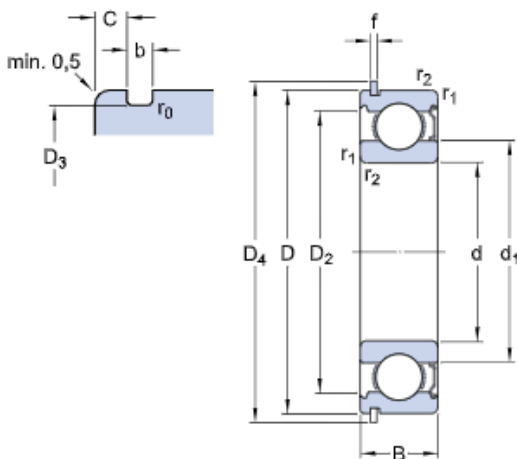

### DIMENSIONS

d	40 mm	Bore diameter
D	80 mm	Outside diameter
B	18 mm	Width
d <sub>1</sub>	≈ 52.6 mm	Shoulder diameter
D <sub>2</sub>	≈ 69.8 mm	Recess diameter
D <sub>3</sub>	76.81 mm	Diameter of snap ring groove
D <sub>4</sub>	86.6 mm	Outside diameter of snap ring
b	1.9 mm	Width of snap ring groove
C	3.28 mm	Distance outer ring from side face to snap ring groove
f	1.7 mm	Width of snap ring
r <sub>0</sub>	max. 0.6 mm	Bottom radius of snap ring groove
r <sub>1,2</sub>	min. 1.1 mm	Chamfer dimension

### ABUTMENT DIMENSIONS

d <sub>a</sub>	min. 47 mm	Diameter of shaft abutment
d <sub>a</sub>	max. 52.5 mm	Diameter of shaft abutment
D <sub>a</sub>	max. 73 mm	Diameter of housing abutment

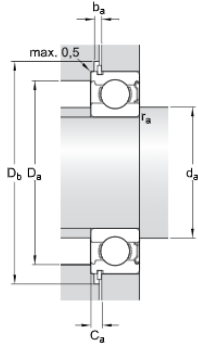

Db	min. 88 mm	Diameter of snap ring recess in the housing
ba	min. 2.2 mm	Width of snap ring recess in the housing
Ca	max. 4.98 mm	Distance from outer ring side face to snap ring back face
ra	max. 1 mm	Radius of shaft or housing fillet

CALCULATION DATA

C	32.5 kN	Basic dynamic load rating
C <sub>0</sub>	19 kN	Basic static load rating
P <sub>u</sub>	0.8 kN	Fatigue load limit
	18 000 r/min	Reference speed
	11 000 r/min	Limiting speed
k <sub>r</sub>	0.025	Minimum load factor
f <sub>0</sub>	14	Calculation factor

MASS

	0.39 kg	Mass bearing
--	---------	--------------

INCLUDED PRODUCTS

SP 80	Snap ring
-------	-----------

TOLERANCE CLASS

P6	Dimensional tolerances
P6	Radial run-out